

Anti-explosion trolley



Two different contact material is the key, for example, C-Track is steel and the bearing is must be stainless steel or plastic, and the support saddle is also made by stainless steel or plastic.

Type	Order-NO.
C32AMC-70	711208
C32ASC-70	711108
C40AMC-70	721208
C40ASC-70	721108

Tow steel wire

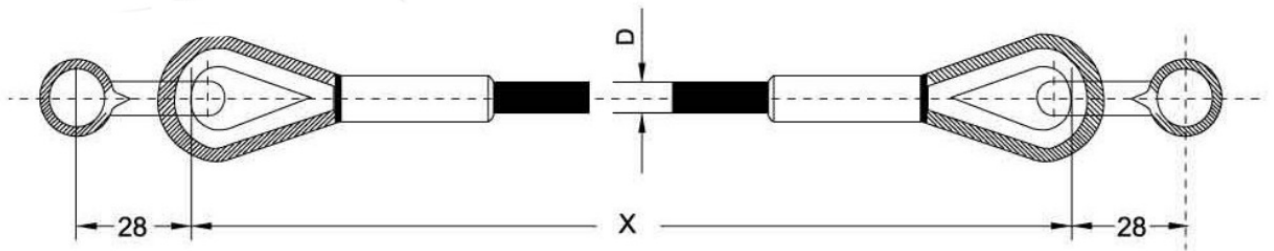

How to determine length of rope

$$X = \frac{S(f - 0.1) + Z}{n} + 2Y$$

- X= Length of tow rope (mm)
- S= Travel distance (mm)
- f= Cable safety factor (e.g. 1.1/1.15/1.2)
- Z= Open space (min. 1 carrier) mm
- N= Number of loops
- Y= Projecting bumper mm

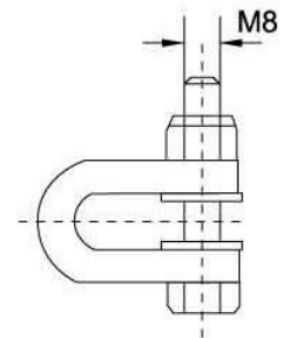

C32 Y=3mm; C40 Y=25mm; C63 Y=35mm

Type	Length or Tow Steel wire	Order-NO.
C32TS-1000	L=1000	711208
C32TS-1500	L=1500	711108
C32TS-2000	L=2000	721208
C32TS-2500	L=2500	721108

SYSTEM PHOTO OF I-BEAM TROLLEY

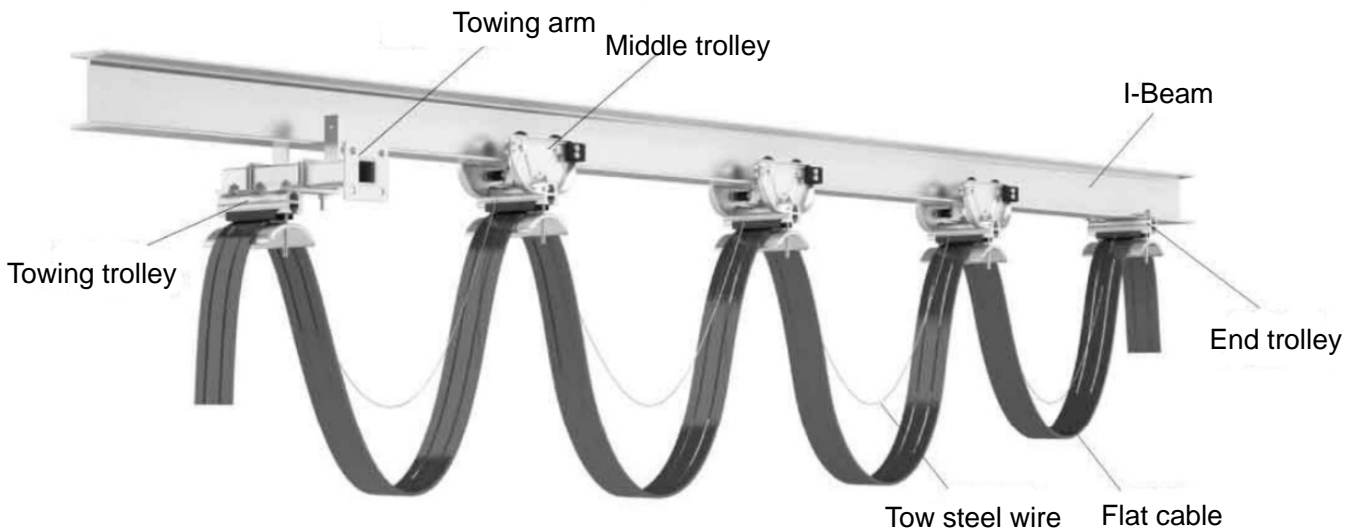

This series of I-Beams trolleys and components integrating our worldwide job proven flat cable provides a safe, efficient and maintenance free method of mobile electrification. The minimum bending radius permissible for flat cable is 5 times the thickness of the cable, thus allowing a considerably smaller bend radius compared to round cable of equal conductor size. Large to round cable of equal conductor size. Large quantities of conductors are handled and the high Komay quality of I-Beam track supported festoon cable equipment guarantees extra long life.

MIDDLE TROLLEY ON I-BEAM

	Type	W35MC-120	W35MC-150	W55MC-250	W55MC-350
	Wheels	Ball bearing, hardened, galvanized Temperature resistance Lub. grease of wheel:-30 °Cto+125°C Traveling Speed: ca. 300m/min.			
	Material	Carrier body: steel, galvanized Support saddle: steel, galvanized Dowel: Steel, galvanized Hardware: galvanized Temperature resistance:-30 °Cto+100°C			
	Max.cable load	Max.50 kg	Max.60 kg	Max.120 kg	Max.150 kg
	Dim.of Cable (mm)	max.120W×50 δ	max.150W×50δ	max.250W×70δ	max. 300W×70δ
	Weight(kg)	2.02	2.18	3.65	5.85
	Cat.-NO.	773522	773532	775522	775532

TOWING TROLLEY ON I-BEAM

	Type	W35SC-120	W35SC-150	W55SC-250	W55SC-350
	Material	Carrier body: steel, galvanized Support saddle: steel, galvanized Bumper: Neoprene Hardware: galvanized Temperature resistance: -30 °C to +100 °C			
	Max.cable load	Max.50 kg	Max.60 kg	Max.120 kg	Max.150 kg
	Dim.of Cable (mm)	max.120W×50δ	max.150W×50δ	Max.250W×70δ	Max.300W×70δ
	Weight(kg)	1.86	1.95	2.35	4.05
	Cat.-NO.	773521	773531	775521	775531

END TROLLEY ON O-BEAM

	Type	W35EC-120	W35EC-150	W55EC-250	W55EC-350
	Material	Carrier body: steel, galvanized Support saddle: steel, galvanized Bumper: Neoprene Hardware: galvanized Temperature resistance: -30 °C to +100 °C			
	Max.cable load	Max.50 kg	Max.60 kg	Max.120 kg	Max.150 kg
	Dim.of Cable (mm)	max.120W×50δ	max.150W×50δ	Max.250W×70δ	Max.300W×70δ
	Weight(kg)	10.76	0.85	1.55	1.95
	Cat.-NO.	773523	773533	775523	775533

ANGLE STEEL TROLLEY

	Type	flat cable	round cable
	Wheels	Ball bearing, hardened, galvanized Temperature resistance Lub. grease of wheel: -30 °C to +125 °C Traveling Speed: ca. 160m/min.	
	Material	Carrier body: steel, galvanized Support saddle: steel, galvanized Bumper: Neoprene Dowel: Steel, galvanized Hardware: galvanized	
	Max.cable load	Max.50 kg	Max.50 kg
	Dim.of Cable (mm)	Max.75W×50δ	max.D 160
	Weight(kg)	0.93	0.78
	Cat.-NO.	792212	792312

STEEL WIRE TROLLEY

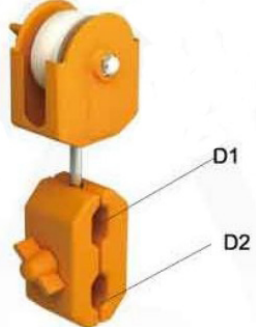
	Type	ST-12/14	ST14/16
	Wheels	Wheels: plastic Temperature resistance Lub. grease of wheel: -30 °C to +125 °C Traveling Speed: ca. 100m/min.	
	Material	Carrier body: ABS Support saddle: ABS Hardware: galvanized	
	Max.cable load	Max.6 kg	Max.7 kg
	Dim.of Cable (mm)	Max.75W×50δ	max.D 160
	Weight(kg)	0.08	0.08